

Assembly Instructions

MODEL NO: ISFD1845

Assembly Instructions

MODEL NO: ISFD1845

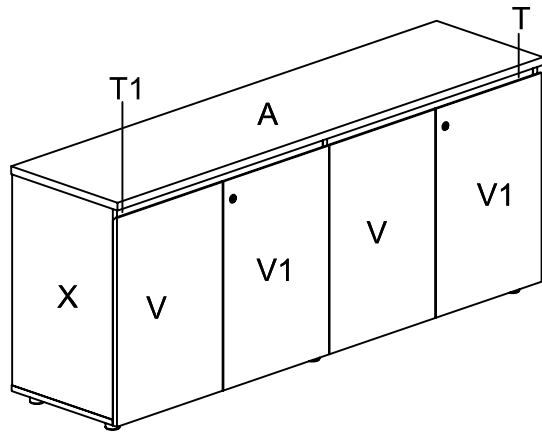

Pin 6x35 1	Shelf Pin 5	Lock 9
33PCS	8PCS	2PCS
Cam 2	Hinge (full-overlay) 6	Wood Screw 4x20 10
28PCS	4PCS	8PCS
Cam Cover 3	Wood Screw 4x16 7	ADJ. Feet ø42x35H 11
33PCS	48PCS	6PCS
Wood Screw 3.5x13 4	Lock Catcher 8	Hinge (half-overlay) 12
28PCS	2PCS	4PCS

STEP5

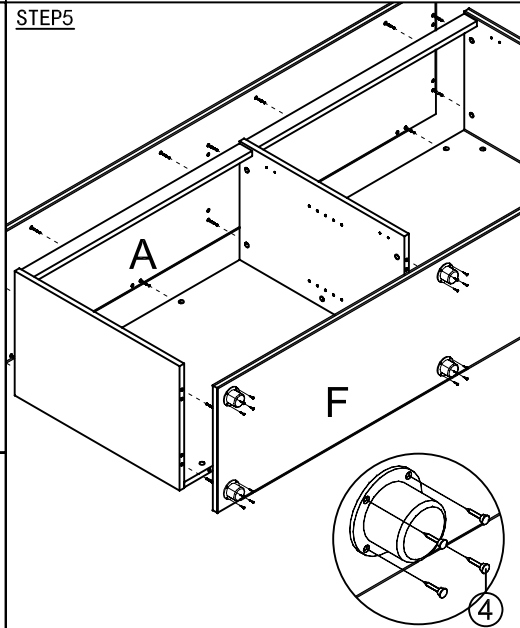

STEP6

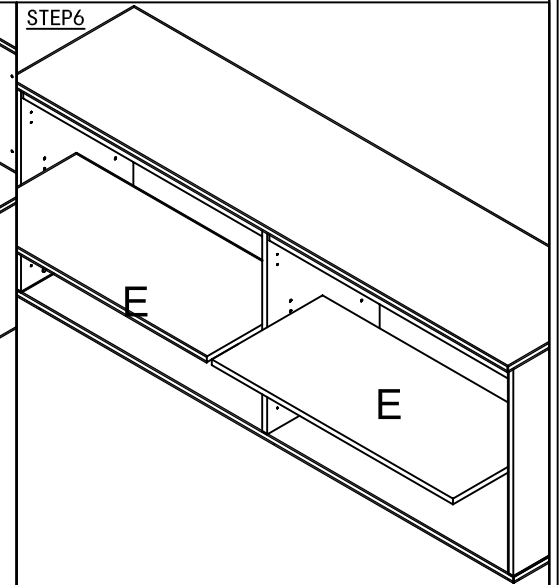

STEP1

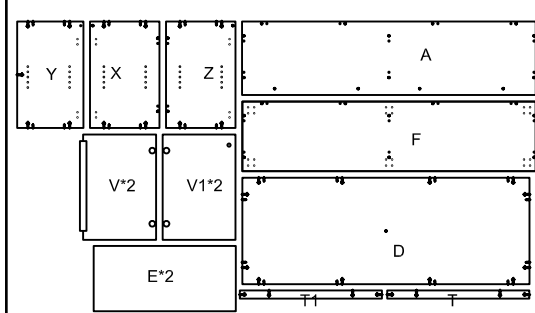

STEP2

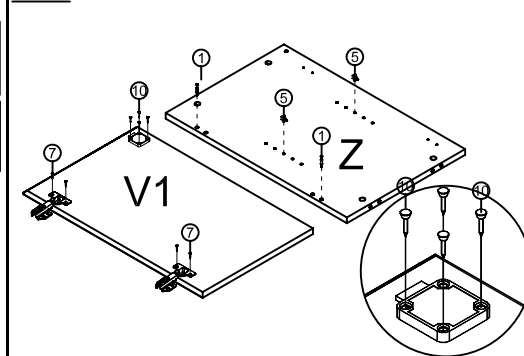

STEP3

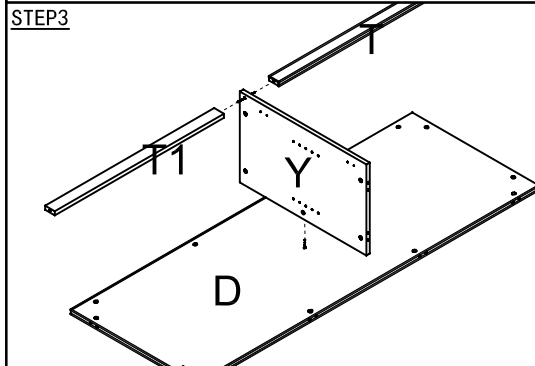

STEP4

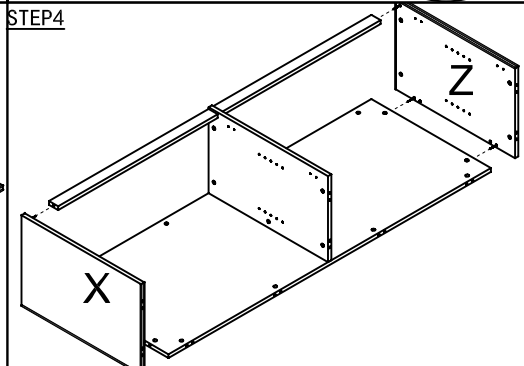

STEP7

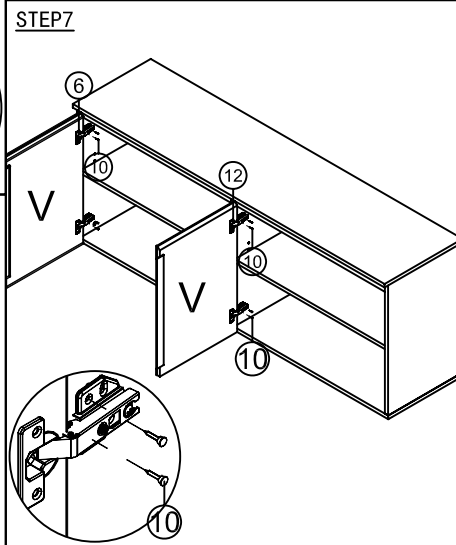

STEP8

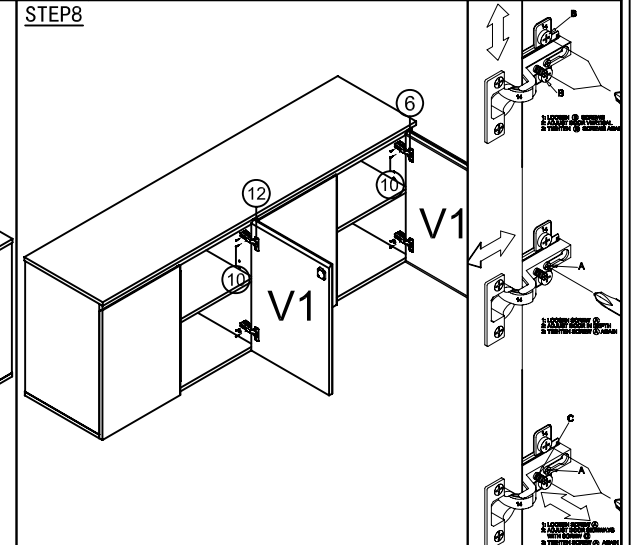

IMPORTANT NOTE:

- Place all laminated parts on a clean and smooth surface such as a rug or carpet to avoid the parts from being scratched.
- Check to be sure that you have all parts and hardware.
- Remove all wrapping materials, including staples & packing straps before you start to assemble.
- Don't tighten all screws/bolts until all completely assembled.
- Keep all hardware parts out of reach of children



IMPORTANT NOTE:

- Place all laminated parts on a clean and smooth surface such as a rug or carpet to avoid the parts from being scratched.
- Check to be sure that you have all parts and hardware.
- Remove all wrapping materials, including staples & packing straps before you start to assemble.
- Don't tighten all screws/bolts until all completely assembled.
- Keep all hardware parts out of reach of children

