

# CAROUSEL LOCKERS

- ▶ Stable, durable and moveable
- ▶ Indoor and outdoor use
- ▶ Eco-friendly
- ▶ Water-Resistant
- ▶ Low Maintenance



# PRODUCT INFORMATION

## PRODUCT SPECIFICATIONS

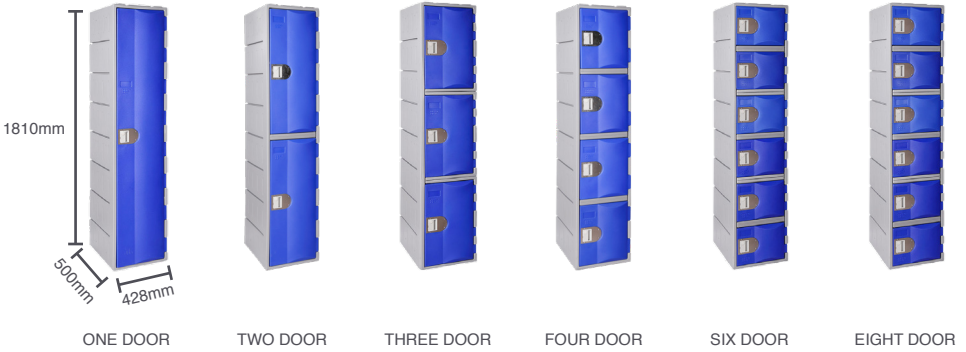

## PRODUCT FEATURES

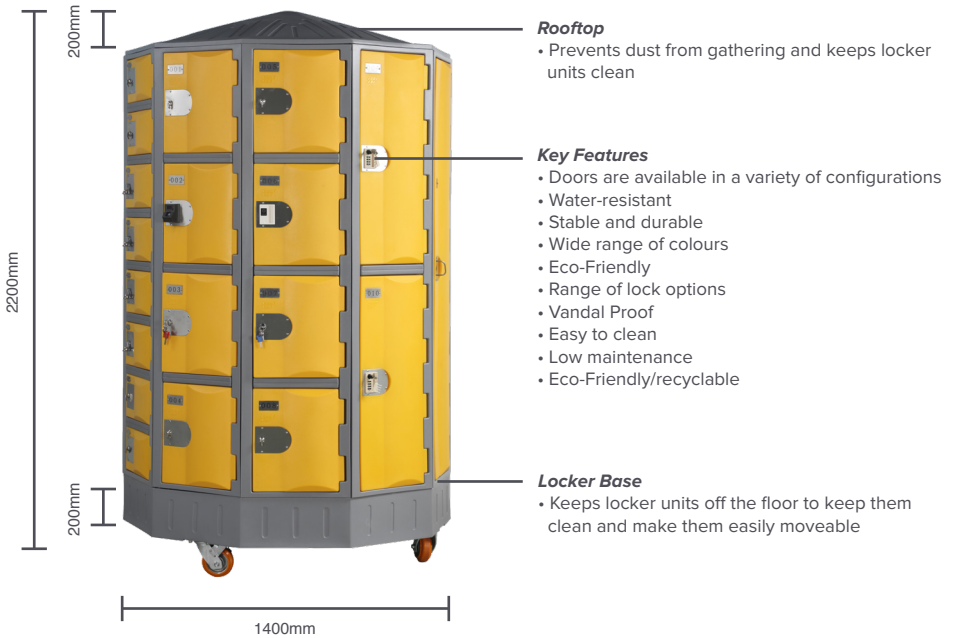

## COLOURS AVAILABLE (10-12 WEEK LEAD TIME)

---

### Carcass:



### Doors:



Custom colours available on request, contact your local sales representative for more information.

## LOCK OPTIONS

---

OLP has a wide variety of lock options to choose from, with varying features and locker compatibility. To discuss which locks would best suit your needs and your locker of preference, contact your local sales representative.

1. Key Lock
2. Pad-latch Lock
3. Combination Lock
4. Coin Lock
5. RFID Lock
6. Digital Lock
7. Fingerprint Lock

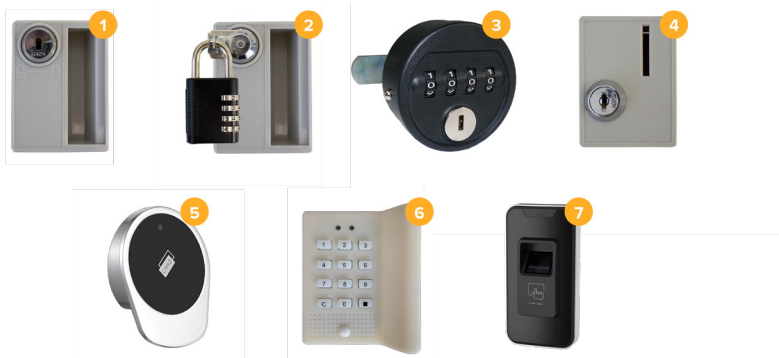

To view OLP's full range of lock options, visit [olp.com.au/lock-specification-sheets](http://olp.com.au/lock-specification-sheets)

## PRODUCT CUSTOMISATION

---

At OLP, we focus on delivering products to our customers that meet their specific requirements. Due to our local Australian manufacturing, if you're looking for a custom size, colour or product, chances are we can do it! Contact your local sales representative for more information.

## ACCESSORIES

---

**A range of optional accessories to increase the lockers functionality.**

- Adjustable shelves
- Hanging Rod
- Number plates
- Sloping Top
- Clothes Hook
- Base