

ARC H LD



The ARC H LD through surface wireless charger offers the ultimate in charging convenience. Designed for table thickness of 20-25 mm*, ARC H LD can be installed without the need to cut into work surfaces.**

OE's patented design uses a resonant coil to focus the energy field and provide maximum efficiency and the fastest possible charging speeds. ARC H LD is available in Basalt Grey with a Basalt Grey resonator pad or in Black with a White resonator pad.

With 15W of charging power ARC H LD is one of the fastest sub surface wireless chargers on the market, convenient for a full charge or a quick boost when you need it most.

*An electronic alignment guide is separately available for surfaces 26 to 50mm thick.

FEATURES

- 15 Watts of charging power
- Fast charge Samsung 10W
- No cut installation
- Foreign object detection



**ARC H LD will not charge the iPhone 12 or iPhone 13 Series

ARC H LD TECHNICAL

SPECIFICATIONS:

Output Power	Up to 15W
Input Power	19V/0.94A
Standby Power	0.2W
Charging Range	20-50mm (coil to coil)
Desk Thickness	No under desk routing for surfaces between 20-50mm thick. Desks 26-50mm require an electronic alignment tool available from OE Elsafe
Certification	IEC 60950-1 (Safety) EN62311 (Health) EN 301 489-1, EN 301 489-3 (EMC)EN 303 417 (Radio)
In The Box	ARC H LD Wireless Charger (1) Power Adapter (1) Resonator Pad (1) Alignment Magnet (1) Alignment Magnet Card Template (1) Cable Clips (3) Installation Manual (1)
ARC-H LD	TBA (Order Code Number)

DIMENSIONS:

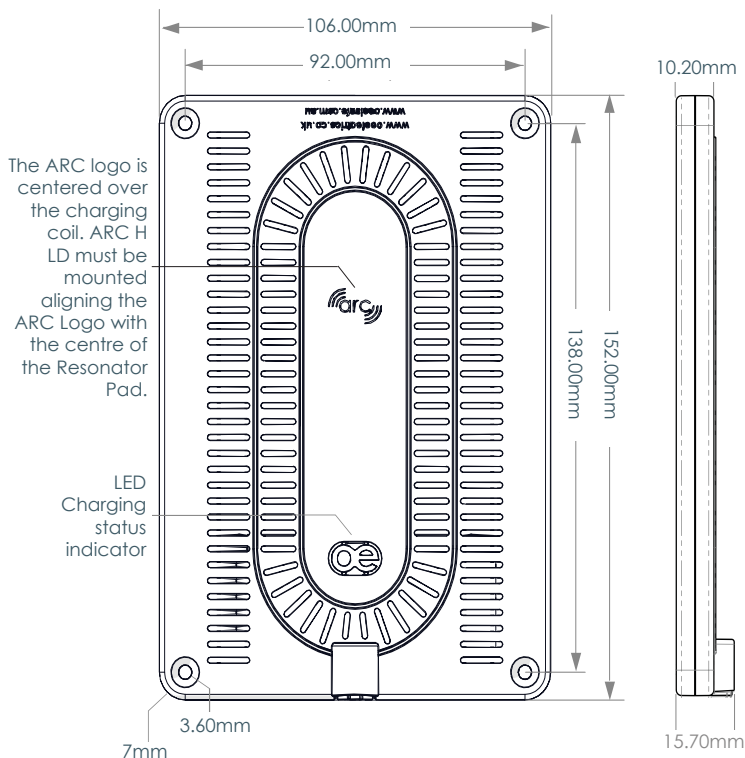

INSTALLATION PLACEMENT:

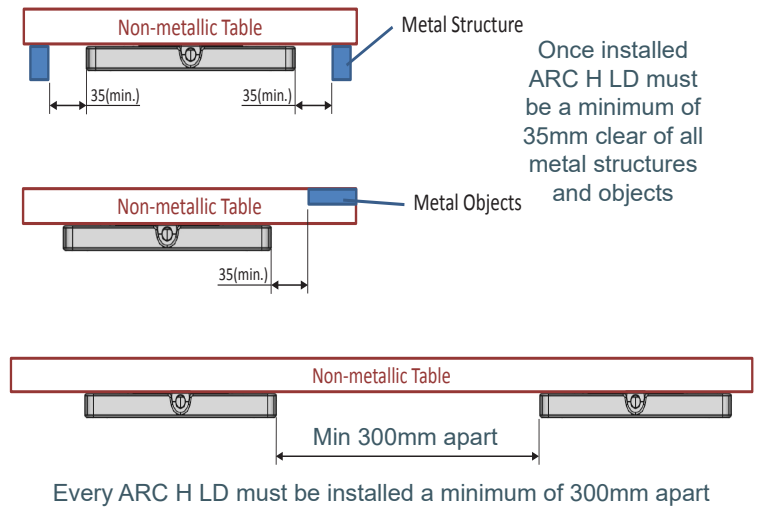

ARC H LD SIDE VIEW:

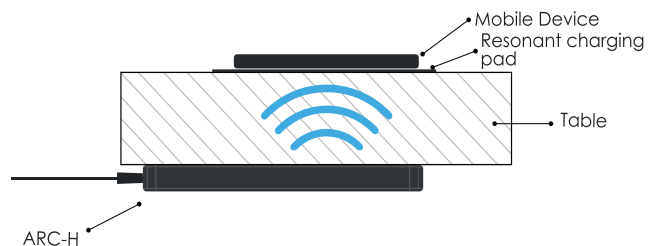

ARC H LD FRONT VIEW:

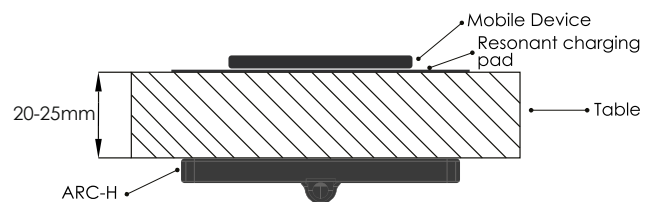

For surface thicknesses 26-50 mm an electronic alignment guide is required and separately available from OE Elsafe.



Scan or click [HERE](#) to view Installation Video. Accurate installation of ARC H LD optimises charging performance

ARC H LD INSTALLATION

ARC H LD is designed for surfaces 20-50mm thick. For surfaces 20-25mm use the in box magnetic alignment card and template. For surfaces 25-50mm an electronic alignment guide is separately available.

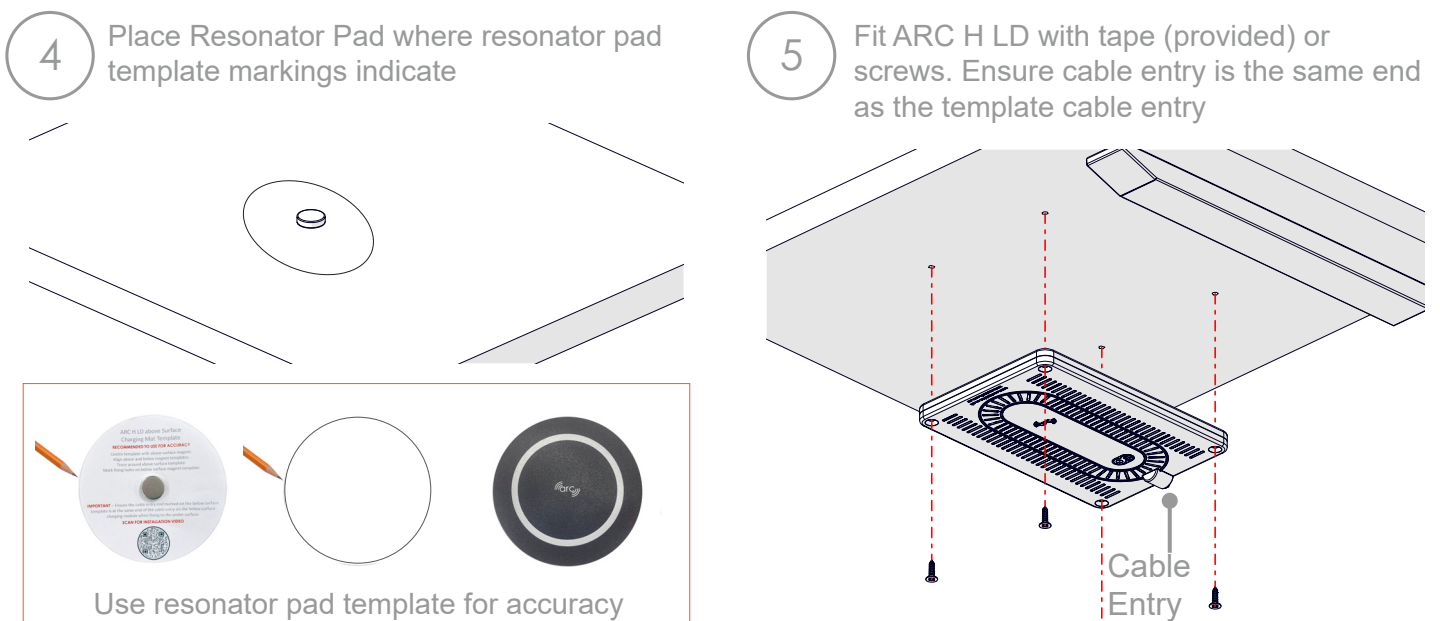
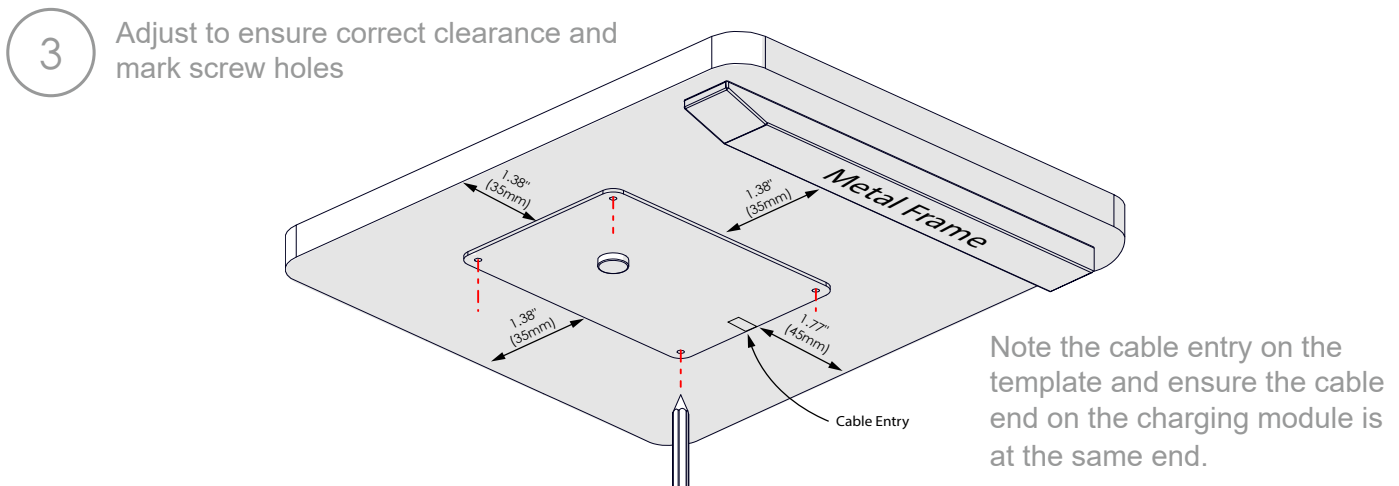
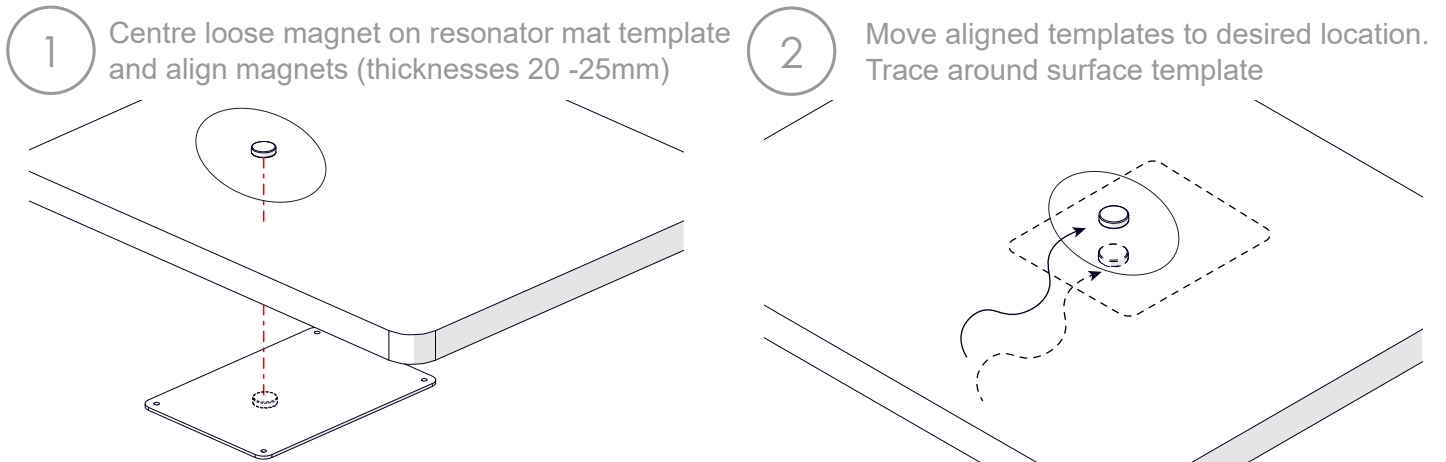

ARC H LD INSTALLATION

6 Connect power and check for blue LED

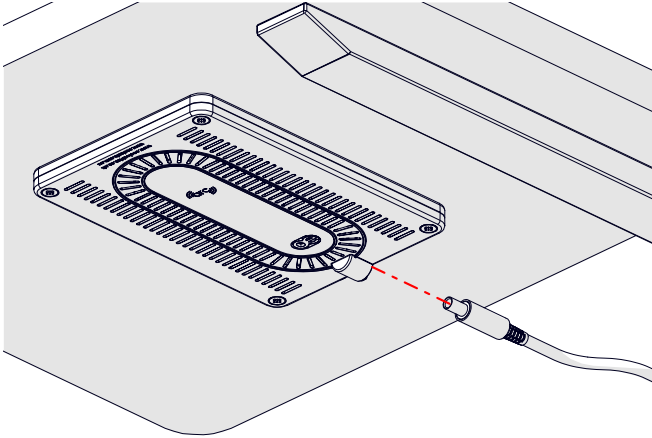

7 Place phone on the Resonator Pad to charge

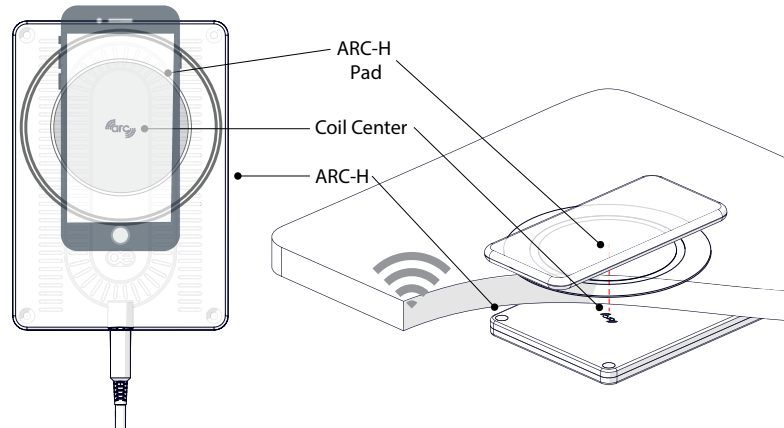

The ARC logo identifies the coil center which must be aligned with the resonator pad

8 The ARC logo identifies the coil center which must be aligned with the Resonator Pad

9 Common queries / installation problems

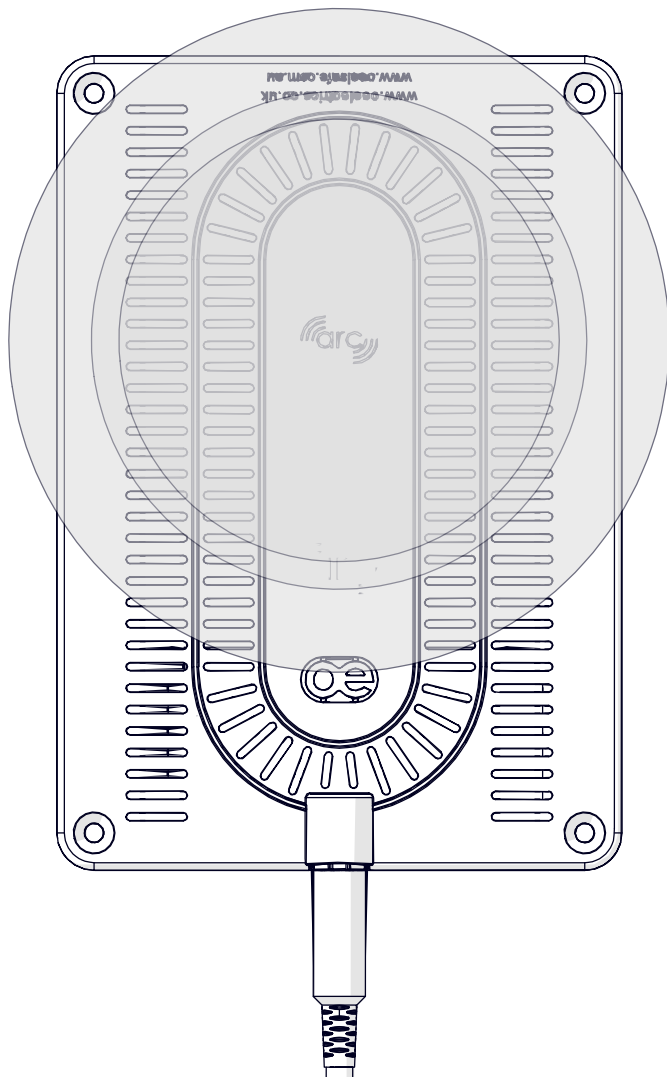

Common queries

The phone will not charge when I place the phone directly on the charger, to check it works before installation?

The charger will not charge a phone unless it is separated (and aligned) from the phone by at least 0.8"(20mm)

The magnets will not attract each other through my desk?

The magnets only work up to 1"(25mm). Either route the desk underside to <1" (25mm) thick or call to purchase the Electronic Alignment Guide

Common installation errors

Pad fitted over the center of the charger - WILL NOT WORK

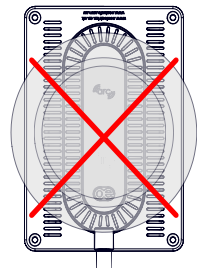

The charging coil is Off-Center, the alignment guide must be used to guarantee accuracy

Pad misaligned - WILL NOT WORK
The alignment guide must be used to guarantee accuracy

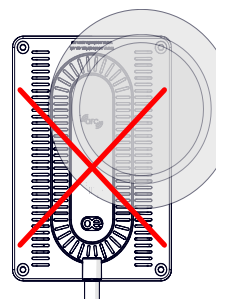

LED Functions

Slow on/off blue - Device is on and in stand-by mode

Solid blue - Device in on and in charging mode

Red - Error mode

- **Foreign Object Detected** - Remove metal from near charger

- **Phone is too close** - Move phone greater than 15mm away

- **Plug pack issue** - Use only original plug pack

- **NON-compatible device** - Upgrade phone